

FOUNDATION RECOMMENDATIONS

- 1) PUMP TO BE MOUNTED ON A FOUNDATION SUFFICIENTLY SUBSTANTIAL TO ABSORB ANY VIBRATION.
- 2) PLINTH SHOULD WEIGH AT LEAST 2« TIMES THE SHIPPING WEIGHT OF THE PUMP & HAVE A MINIMUM HEIGHT OF 300mm. PLINTH SHOULD BE KEYED INTO FLOOR. NB APPROX WEIGHT OF CONCRETE = 2200kg/m³
- 3) PLINTH SHOULD BE LARGER BY AT LEAST 300mm THAN PUMP BASEPLATE AS SHOWN

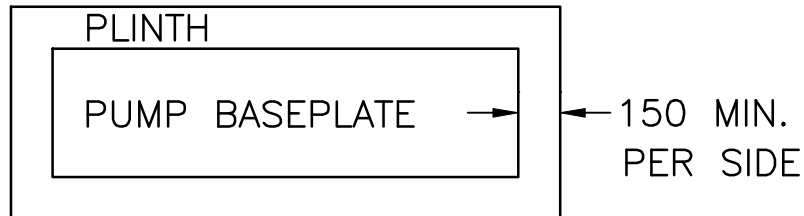

- 4) PUMP BASEPLATE SHOULD BE LEVELLED USING PACKING/SHIMS. GAP BETWEEN PLINTH & PUMP BASEPLATE TO BE 25mm FOR GROUTING.
- 5) FOUNDATION BOLTS SHOULD BE FITTED INTO TAPER POCKETS AS SHOWN BELOW.

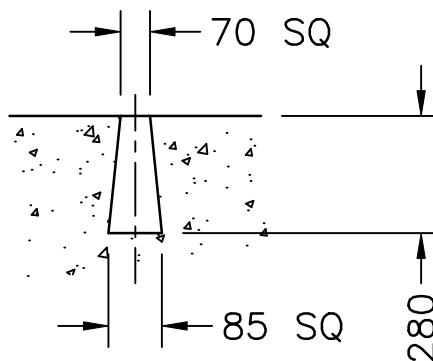

© ARMSTRONG PUMPS LIMITED

All dimensions in millimetres unless otherwise stated

Third Angle Projection		Tolerances (general)	Linear ± 0.5 Angular ± 0.5°	F	E	D	C	B	A	ARMSTRONG PUMPS LTD COLCHESTER ESSEX UK			
SCALE	DATE	Material								TITLE			
--	5Jul95									FOUNDATION RECOMMENDATIONS FIRE PUMPS			
DETAIL NAME	CHECKED	Structural sections to BS4 part 1 Hollow sections to BS4848 part 2								DRAWING NUMBER			
05493290										UKD05493-290			
A4	DRAWN DCA	REV	ECO No.	DATE	SIGN								