

## Series 4280 End Suction Motor Mounted Pump

# 3 x 3 x 5

# SUBMITTAL

JOB: _____	REPRESENTATIVE: _____
ENGINEER: _____	ORDER NO: _____ DATE: _____
CONTRACTOR: _____	SUBMITTED BY: _____ DATE: _____
	APPROVED BY: _____ DATE: _____

PUMP DESIGN DATA			
NO. OF PUMPS:	TAG:		
CAPACITY: _____ L/s (USgpm)	HEAD: _____ m (ft)		
LIQUID: _____	VISCOSITY: _____		
TEMPERATURE: _____ °C (°F)	SPECIFIC GRAVITY: _____		

MOTOR DESIGN DATA			
HP: _____	RPM: _____		
FRAME SIZE: _____	ENCLOSURE: _____		
VOLTS: _____	HERTZ: 50Hz	PHASE: _____	
EFFICIENCY: _____	<input type="checkbox"/> STANDARD	<input type="checkbox"/> PREMIUM	

MATERIALS OF CONSTRUCTION				
FLANGE RATING	<input type="checkbox"/> ANSI 125		<input type="checkbox"/> ANSI 250	
CONSTRUCTION	<input type="checkbox"/> BRONZE FITTED	<input type="checkbox"/> ALL IRON	<input type="checkbox"/> BRONZE FITTED	<input type="checkbox"/> ALL IRON
CASING	CAST IRON		DUCTILE IRON	
IMPELLER	BRONZE	C.I	BRONZE	C.I
GASKET	CONFINED FIBER			
ADAPTER	CAST IRON		DUCTILE IRON	
SHAFT	CARBON STEEL			
SHAFT SLEEVE	BRONZE	316 SS	BRONZE	316 SS
MAX. PUMP OPERATING CONDITIONS	12 bar at 60°C (175 psig at 140°F)		17 bar at 38°C (250 psig at 100°F)	
	10 bar at 107°C (140 psig at 225°F)		14 bar at 121°C (200 psig at 250°F)	

MECHANICAL SEAL DESIGN DATA		
STYLE	SINGLE SPRING	NOT SUITABLE FOR USE ON OIL SERVICE
TYPE	TYPE 21A	
ROTATING FACE	CARBON	
STATIONARY SEAT	SILICON-CARBIDE	
SECONDARY SEAL	EPDM*	
SPRINGS	STAINLESS STEEL	
ROTATING HARDWARE	STAINLESS STEEL	

OPTIONAL EQUIPMENT

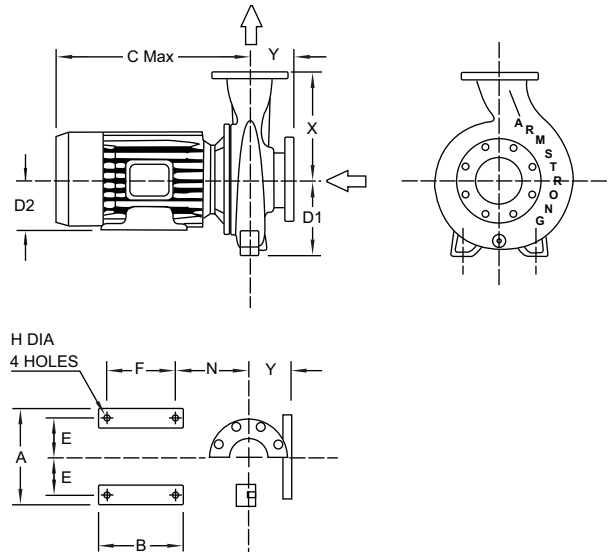

- TOLERANCE OF ±3 mm (±0.125") SHOULD BE USED.
- FOR EXACT INSTALLATION DATA PLEASE WRITE FACTORY FOR CERTIFIED DIMENSIONS.
- SEE PERFORMANCE CURVES ON PAGE 2.
- PUMP EQUIPPED WITH CASING DRAIN PLUG AND 1/4" NPT SUCTION AND DISCHARGE GAUGE PORTS

MOTOR HORSEPOWER ODP & TEFC	FRAME	MAX. DIMENSIONS mm (ins)												ASSEMBLY WEIGHT		
		A	B	C MAX		D1	D2	E	F	H	N	X	Y	kg (lbs)		
				ODP	TEFC									ODP	TEFC	
---	0.25 - 0.75	56C	178 (7.00)	127 (5.00)	298 (11.74)	301 (11.84)	143 (5.63)	89 (3.50)	70 (2.75)	102 (4.00)	9 (0.34)	168 (6.63)	200 (7.88)	102 (4.00)	56.8 (125)	61.3 (135)
1	---	143JM	178 (7.00)	127 (5.00)	392 (15.43)	417 (16.43)	143 (5.63)	89 (3.50)	70 (2.75)	102 (4.00)	9 (0.34)	168 (6.63)	200 (7.88)	102 (4.00)	59.0 (130)	61.3 (135)
1.5	---	143JM	178 (7.00)	152 (6.00)	414 (16.31)	440 (17.31)	143 (5.63)	89 (3.50)	70 (2.75)	127 (5.00)	9 (0.34)	168 (6.63)	200 (7.88)	102 (4.00)	59.0 (130)	61.3 (135)
2	---	145JM	229 (9.00)	146 (5.75)	449 (17.68)	459 (18.06)	143 (5.63)	114 (4.50)	95 (3.75)	114 (4.50)	10 (0.41)	187 (7.38)	200 (7.88)	102 (4.00)	61.3 (135)	70.4 (155)
3	---	182JM	229 (9.00)	171 (6.75)	459 (18.06)	460 (18.10)	143 (5.63)	114 (4.50)	95 (3.75)	140 (5.50)	10 (0.41)	187 (7.38)	200 (7.88)	102 (4.00)	74.9 (165)	74.9 (165)

Note : All dimensions are in mm (inches) and weights in kg (lbs)

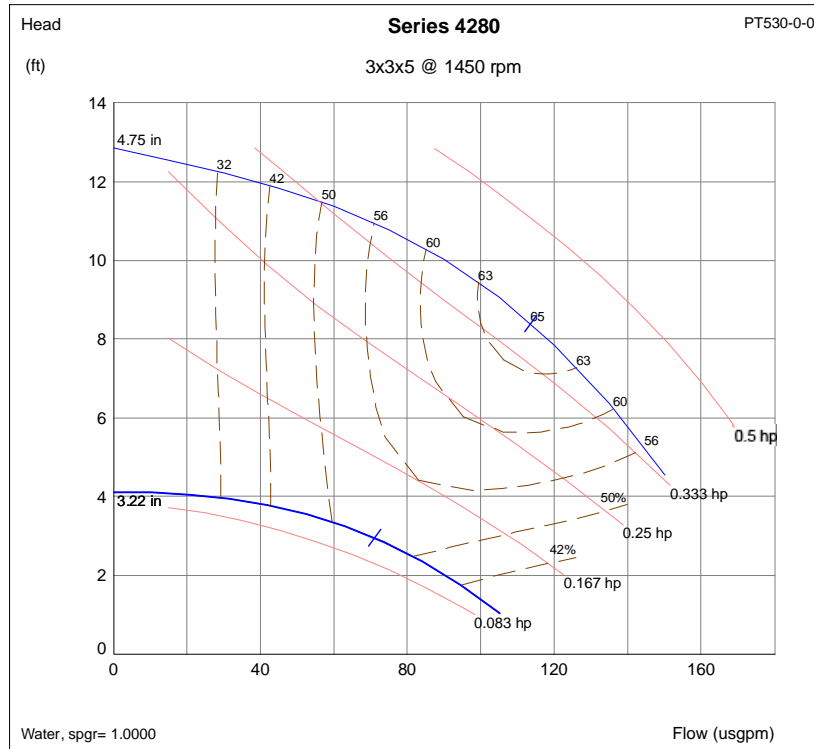
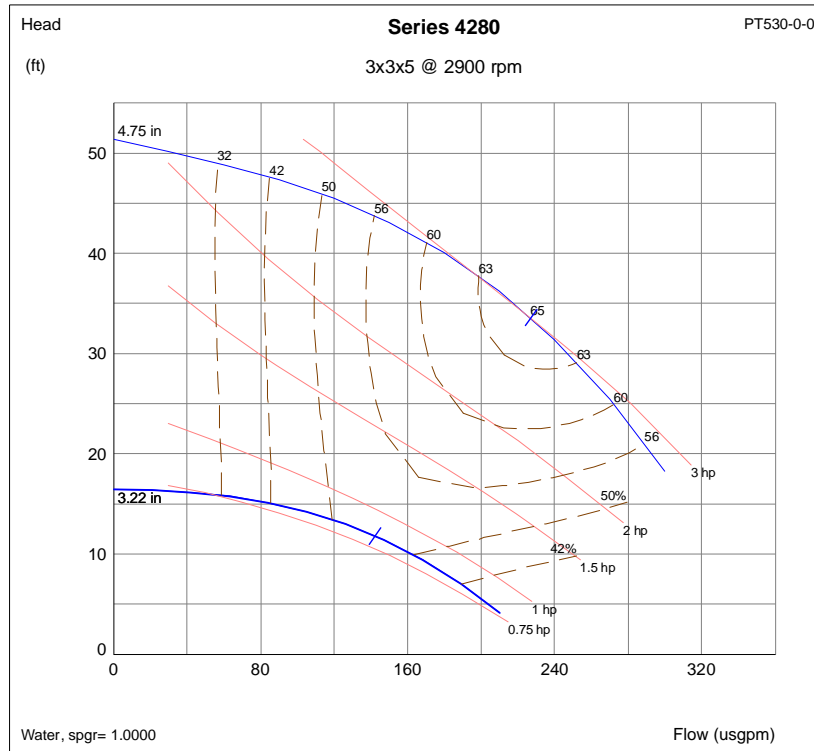

**S. A. Armstrong Limited**  
23 Bertrand Avenue  
Toronto, Ontario  
Canada, M1L 2P3  
T: (416) 755-2291  
F (Main): (416) 759-9101

**Armstrong Pumps Inc.**  
93 East Avenue  
North Tonawanda, New York  
U.S.A. 14120-6594  
T: (716) 693-8813  
F: (716) 693-8970

**Armstrong Holden Brooke Pullen**  
Wenlock Way  
Manchester  
United Kingdom, M12 5JL  
T: +44 (0) 161 223 2223  
F: +44 (0) 161 220 9660



© S.A. Armstrong Limited 2009