



FILE NO: 42.52
 DATE: Dec. 15, 2010
 SUPERSEDES: 42.52
 DATE: Apr. 28, 2010

Series 4280
End Suction Motor Mounted Pump

3 x 3 x 5

SUBMITTAL

JOB: _____ REPRESENTATIVE: _____

ENGINEER: _____ ORDER NO: _____ DATE: _____

CONTRACTOR: _____ SUBMITTED BY: _____ DATE: _____

APPROVED BY: _____ DATE: _____

PUMP DESIGN DATA			
NO. OF PUMPS:	TAG:		
CAPACITY:	USgpm (L/s)	HEAD:	ft (m)
LIQUID:	VISCOSITY:		
TEMPERATURE:	°F (°C)	SPECIFIC GRAVITY:	
SIZE:	SUCTION - 3" (75 mm) Flanged	DISCHARGE - 3" (75 mm) Flanged	

MOTOR DESIGN DATA			
HP:	RPM:		
FRAME SIZE:	ENCLOSURE:		
VOLTS:	HERTZ: 60 Hz	PHASE:	
EFFICIENCY*:	<input type="checkbox"/> ENERGY EFF (12.11)	<input type="checkbox"/> NEMA PREMIUM (12.12)	

* Fractional power & Frame 56 motors are supplied with the standard efficiency of the manufacturer

MATERIALS OF CONSTRUCTION				
FLANGE RATING	ANSI 125		ANSI 250	
CONSTRUCTION	<input type="checkbox"/> BF	<input type="checkbox"/> AI	<input type="checkbox"/> DBF	<input type="checkbox"/> DI
CASING	CAST IRON		DUCTILE IRON	
IMPELLER	BRONZE	C.I	BRONZE	C.I
GASKET	CONFINED FIBER			
ADAPTER	CAST IRON		DUCTILE IRON	
SHAFT	CARBON STEEL			
SHAFT SLEEVE	BRONZE	316 SS	BRONZE	316 SS
MAX. PUMP OPERATING CONDITIONS	175 psig at 150°F (12 bar at 65°C)		300 psig at 150°F (20 bar at 65°C)	
	140 psig at 250°F (10 bar at 121°C)		250 psig at 250°F (17 bar at 121°C)	

MECHANICAL SEAL DESIGN DATA		
FLUID TYPE	NON-POTABLE	POTABLE (DRINKING) WATER
SEAL TYPE	2A	
ROTATING FACE	ANTIMONY LOADED CARBON	RESIN BONDED CARBON
STATIONARY SEAT	SILICON CARBON	
SECONDARY SEAL	VITON	EPDM
SPRING	STAINLESS STEEL	
ROTATING HARDWARE	STAINLESS STEEL	

OPTIONAL EQUIPMENT

- TOLERANCE OF ±0.125" (±3 mm) SHOULD BE USED
- FOR EXACT INSTALLATION DATA PLEASE WRITE FACTORY FOR CERTIFIED DIMENSIONS.
- SEE PERFORMANCE CURVES ON PAGE 2.
- PUMP EQUIPPED WITH CASING DRAIN PLUG AND 1/4" NPT SUCTION AND DISCHARGE GAUGE PORTS

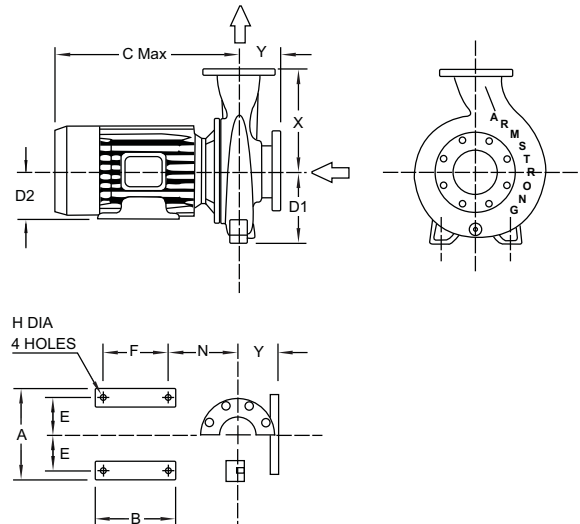

MOTOR HORSEPOWER		FRAME	MAX. DIMENSIONS - inches (mm)												* ASSEMBLY WEIGHT	
ODP & TEFC			A	B	C MAX		D1	D2	E	F	H	N	X	Y	lbs (kg)	
3600	1800				ODP	TEFC									ODP	TEFC
---	0.25 - 0.75	56C	7.00 (178)	5.00 (127)	11.74 (298)	11.80 (301)	5.63 (143)	3.50 (89)	2.75 (70)	4.00 (102)	0.34 (9)	6.63 (168)	7.88 (200)	4.00 (102)	125 (56.8)	135 (61.3)
1.5	---	143JM	7.00 (178)	5.00 (127)	15.43 (392)	16.40 (417)	5.63 (143)	3.50 (89)	2.75 (70)	4.00 (102)	0.34 (9)	6.63 (168)	7.88 (200)	4.00 (102)	130 (59.0)	135 (61.3)
2	---	145JM	7.00 (178)	6.00 (152)	16.31 (414)	17.30 (440)	5.63 (143)	3.50 (89)	2.75 (70)	5.00 (127)	0.34 (9)	6.63 (168)	7.88 (200)	4.00 (102)	130 (59.0)	135 (61.3)
3	---	182JM	9.00 (229)	5.75 (146)	17.68 (449)	18.10 (459)	5.63 (143)	4.50 (114)	3.75 (95)	4.50 (114)	0.41 (10)	7.38 (187)	7.88 (200)	4.00 (102)	135 (61.3)	155 (70.4)
5	---	184JM	9.00 (229)	6.75 (171)	18.06 (459)	18.10 (460)	5.63 (143)	4.50 (114)	3.75 (95)	5.50 (140)	0.41 (10)	7.38 (187)	7.88 (200)	4.00 (102)	165 (74.9)	165 (74.9)

Note : All dimensions are in inches (mm) and weights in lbs (kg)
 * Assembly weight combines pump and motor

ARMSTRONG



PERFORMANCE CURVES

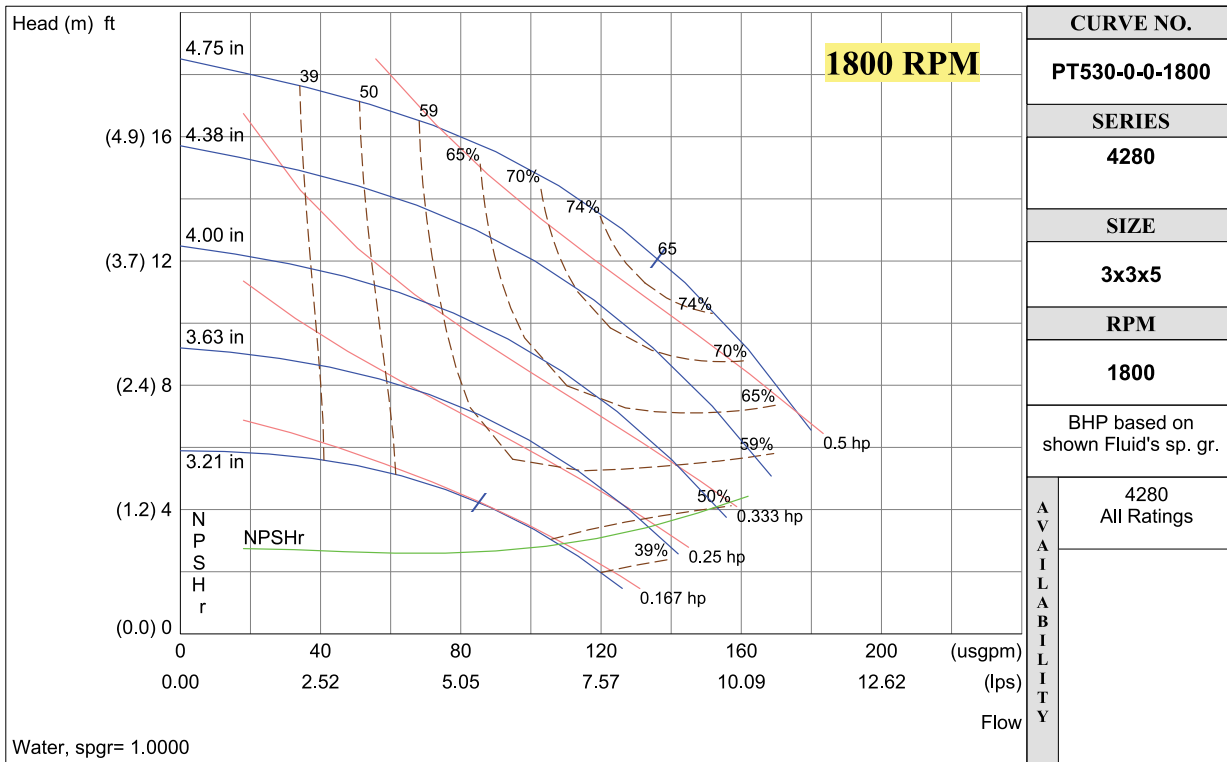
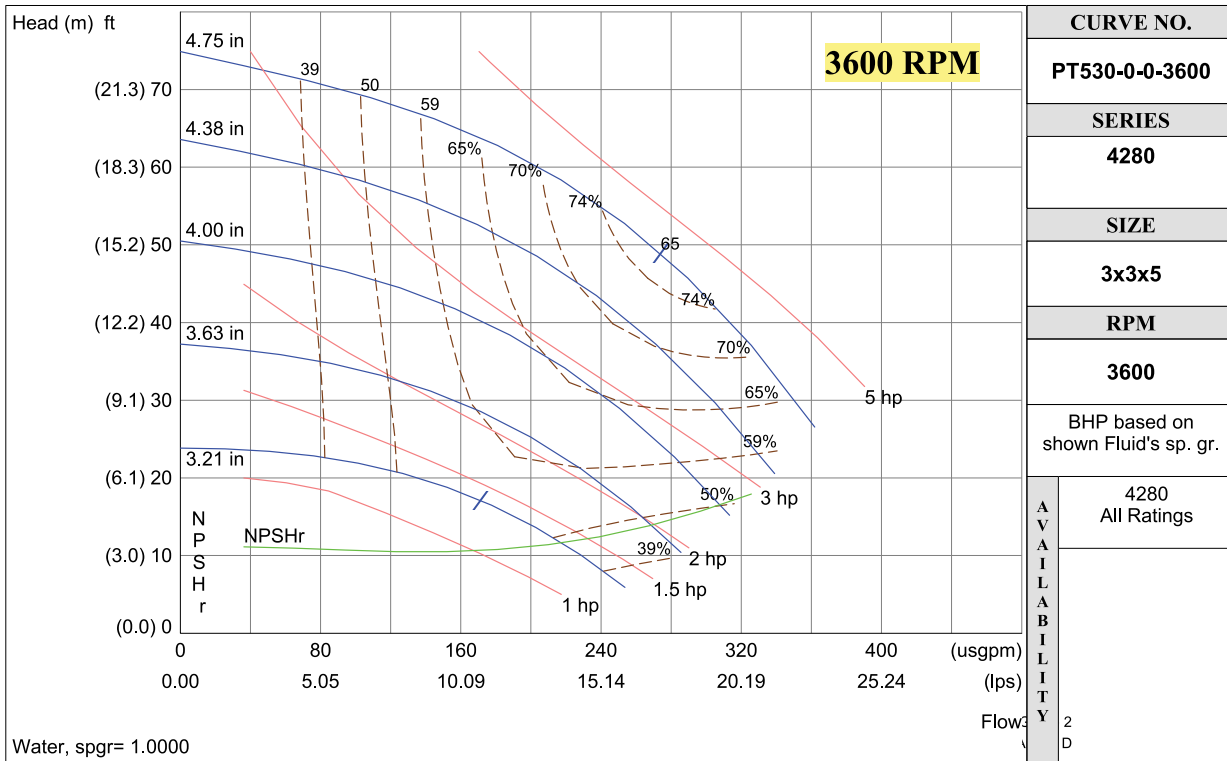

S. A. Armstrong Limited
 23 Bertrand Avenue
 Toronto, Ontario
 Canada, M1L 2P3
 T: 416-755-2291
 F: 416-759-9101

Armstrong Pumps Inc.
 93 East Avenue
 North Tonawanda, New York
 U.S.A. 14120-6594
 T: 716-693-8813
 F: 716-693-8970

Armstrong Integrated Limited
 Wenlock Way
 Manchester
 United Kingdom, M12 5JL
 T: +44 (0) 8444 145 145
 F: +44 (0) 8444 145 146



© S.A. Armstrong Limited 2010

For Armstrong locations worldwide, please visit www.armstrongintegrated.com