



FILE NO.:	6042.128
DATE:	January 5, 2012
SUPERSEDES:	6042.128
DATE:	September 28, 2011

PARTS LIST

SERIES 4280

"CLOSE COUPLLED"
OR
MOTOR MOUNTED PUMP

CENTERLINE DISCHARGE
"M" DESIGNATION

1-1/4" IMPELLER BORE -- 1-5/8" MECHANICAL SEAL

NEW DESIGN

4280 POWER FRAMES: ALL SPEEDS

SPEED	MOTOR HORSEPOWER																		
	3/4	1	1 1/2	2	3	5	3	5	7 1/2	10			15	20			25	30	
1150 RPM																			
1750 RPM	1	1 1/2 & 2	3	5	7 1/2	10	7 1/2	10	15	20			25	30			40	50	
3500 RPM	1 1/2	2 & 3	5	7 1/2	10	15	10	15	20	25	30	40			50	60			
FRAME	143JM	145JM	182JM	184JM	213JM	215JM	213JP	215JP	254JM	256JM	284JM	286JM	284JP	286JP	324JM	326JM	324JP	326JP	
PUMP SIZE																			
1 1/2 X 1 X 6	S	S	S	S	S														
3 X 1 1/2 X 6	S	S	S	S	S	S													
3 X 2 X 6	S	S	S	S	S	S													
3 X 2 1/2 X 6	S	S	S	S	S	S													
4 X 3 X 6W	S	S	S	S	S	S			M	M									
1 1/2 X 1 X 8	S	S	S	S			M	M											
3 X 1 1/2 X 8	S	S	S	S			M	M	M	M	M	M			M	M			
3 X 2 X 8	S	S	S	S			M	M	M	M	M	M			M	M			
3 X 2 1/2 X 8	S	S	S	S			M	M	M	M	M	M			M	M			
4 X 3 X 8	S	S	S	S			M	M	M	M	M	M			M	M			
5 X 4 X 8	S	S	S	S			M	M	M	M	M	M			M	M			
6 X 4 X 8	S	S	S	S			M	M	M	M	M	M			M	M			
8 X 8 X 8			S	S			M	M	M	M					M	M			
2 X 1 X 10	S	S	S	S			M	M	M	M			M	M			M	M	
2 X 1.5 X 10	S	S	S	S			M	M	M	M			M	M			M	M	
3 X 1 1/2 X 10	S	S	S	S			M	M	M	M			M	M			M	M	
3 X 2 X 10	S	S	S	S			M	M	M	M			M	M			M	M	
3 X 2 1/2 X 10	S	S	S	S			M	M	M	M			M	M			M	M	
4 X 3 X 10			S	S			M	M	M	M									
5 X 4 X 10							M	M	M	M			M	M			M	M	
6 X 4 X 10							M	M	M	M			M	M					
6 X 5 X 10							M	M	M	M			M	M			M	M	
8 X 6 X 10							M	M	M	M			M	M			M	M	
4 X 3 X 11 1/2				S			M	M	M	M			M	M					
5 X 4 X 11 1/2							M	M	M	M			M	M					
6 X 5 X 11 1/2									M	M			M	M			M	M	
8 X 6 X 11 1/2									M	M			M	M			M	M	
3 X 1 1/2 X 13									M	M			M	M	M	M	M	M	
3 X 2 X 13									M	M			M	M	M	M			
4 X 3 X 13									M	M			M	M	M	M	M	M	
6 X 4 X 13									M	M			M	M	M	M	M	M	
6 x 5 x 13									M	M			M	M	M	M	M	M	
6 x 5 x 13H									M	M			M	M	M	M	M	M	
8 X 6 X 13									M	M			M	M	M	M	M	M	

"S" DESIGNATION - 7/8" IMPELLER BORE, 1 1/4" MECHANICAL SEAL

"M" DESIGNATION - 1 1/4" IMPELLER BORE, 1 5/8" MECHANICAL SEAL

4280 NEW STYLE CENTER LINE DISCHARGE, CLOSE COUPLED/ MOTOR MOUNTED PUMP "M" DESIGNATION

1 1/4" IMPELLER BORE -- 1 5/8" MECHANICAL SEAL
EXPLODED VIEW

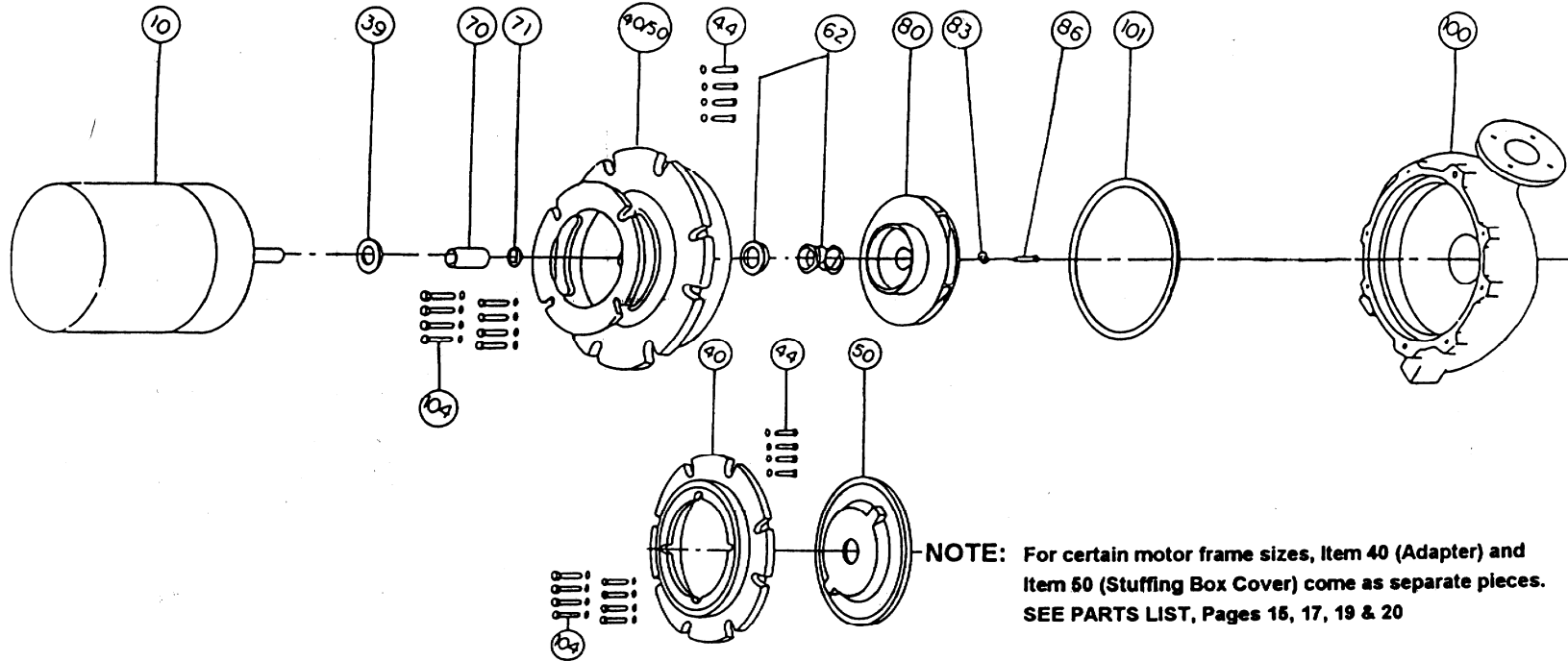

INDEX

ITEM	DESCRIPTION	PAGE	ITEM	DESCRIPTION	PAGE	ITEM	DESCRIPTION	PAGE
39	WATER SLINGER	21	50	STUFFING BOX	17	83	IMPELLER WASHER	21
40	ADAPTER	17	62	MECHANICAL SEAL KIT	21	86	IMPELLER CAPSCREW	21
40/50	ADAPTER/STUFFING BOX B.F. & A.I.	11 & 12	70	SHAFT SLEEVE	21	100	CASING	3, 4, 5, 6 & 7
40/50	ADAPTER/STUFFING BOX D.I.	13 & 14	71	SHAFT SLEEVE SPACER	21	101	CASING GASKET	18
40/50	ADAPTER/STUFFING BOX A.B.	15 & 16	70/71	SHAFT SLEEVE KIT	21	104	ADAPT. STUFF BOX CAPS.	20
44	MOTOR CAPSCREW	19	80	IMPELLER	8, 9 & 10			

4280 PUMP PARTS

CENTERLINE DISCHARGE

"M" SIZE 1 1/4" IMPELLER BORE ----- 1 5/8" MECHANICAL SEAL

ITEM 100 CASING			
PUMP SIZE	CONST.	PART NUMBER	BAR CODE
4 X 3 X 6W	B. F.	427292-011	
4 X 3 X 6W	A. B.	427292-041	
4 X 3 X 6W	D. I.	427293-031	
1 1/2 X 1 X 8	B. F.	426188-011	
1 1/2 X 1 X 8	A. B.	426188-041	
1 1/2 X 1 X 8	D. I.	426189-031	
3 X 1 1/2 X 8	B. F.	426599-011	
3 X 1 1/2 X 8	A. B.	426599-041	
3 X 1 1/2 X 8	D. I.	426600-031	
3 X 2 X 8	B. F.	426125-011	
3 X 2 X 8	A. B.	426125-041	
3 X 2 X 8	D. I.	426126-031	
3 X 2 1/2 X 8	B. F.	427236-011	
3 X 2 1/2 X 8	A. B.	427236-041	
3 X 2 1/2 X 8	D. I.	427237-031	
4 X 3 X 8	B. F.	426129-011	
4 X 3 X 8	A. B.	426129-041	
4 X 3 X 8	D. I.	426130-031	
5 X 4 X 8	B. F.	426107-011	
5 X 4 X 8	A. B.	426107-041	
5 X 4 X 8	D. I.	426108-031	

CASINGS CONTINUED ON PAGE 4

4280 PUMP PARTS

CENTERLINE DISCHARGE

"M" SIZE 1 1/4" IMPELLER BORE ----- 1 5/8" MECHANICAL SEAL

ITEM 100 CASING (cont'd)

PUMP SIZE	CONST.	PART NUMBER	BAR CODE
6 X 4 X 8W	B. F.	426624-011	
6 X 4 X 8W	A. B.	426624-041	
6 X 4 X 8W	D. I.	426625-031	
8 X 8 X 8	B. F.	427913-011	
8 X 8 X 8	A. B.	427913-041	
8 X 8 X 8	D. I.	427914-031	
2 X 1 X 10	B. F.	426137-011	
2 X 1 X 10	A. B.	426137-041	
2 X 1 X 10	D. I.	426138-031	
2 X 1.5 X 10	B. F.	426259-011	
2 X 1.5 X 10	A. B.	426259-041	
2 X 1.5 X 10	D. I.	426260-031	
3 X 1 1/2 X 10	B. F.	426139-011	
3 X 1 1/2 X 10	A. B.	426139-041	
3 X 1 1/2 X 10	D. I.	426140-031	
3 X 2 X 10	B. F.	426143-011	
3 X 2 X 10	A. B.	426143-041	
3 X 2 X 10	D. I.	426144-031	
3 X 2 1/2 X 10	B. F.	427290-011	
3 X 2 1/2 X 10	A. B.	427290-041	
3 X 2 1/2 X 10	D. I.	427291-031	
4 X 3 X 10	B. F.	426149-011	
4 X 3 X 10	A. B.	426149-041	
4 X 3 X 10	D. I.	426150-031	

CASINGS CONTINUED ON PAGE 5

4280 PUMP PARTS

CENTERLINE DISCHARGE

"M" SIZE 1 1/4" IMPELLER BORE ----- 1 5/8" MECHANICAL SEAL

ITEM 100 CASING (cont'd)

PUMP SIZE	CONST.	PART NUMBER	BAR CODE
5 X 4 X 10	B. F.	426111-011	
5 X 4 X 10	A. B.	426111-041	
5 X 4 X 10	D. I.	426112-031	
6 X 4 X 10	B. F.	426153-011	
6 X 4 X 10	A. B.	426153-041	
6 X 4 X 10	D. I.	426154-031	
6 X 5 X 10	B. F.	427238-011	
6 X 5 X 10	D. I.	427238-041	
6 X 5 X 10	B. F.	427238-031	
8 X 6 X 10	B. F.	426605-011	
8 X 6 X 10	A. B.	426605-041	
8 X 6 X 10	D. I.	426606-031	
4 X 3 X 11 1/2	B. F.	426147-011	
4 X 3 X 11 1/2	A. B.	426147-041	
4 X 3 X 11 1/2	D. I.	426148-031	
5 X 4 X 11 1/2	B. F.	426151-011	
5 X 4 X 11 1/2	A. B.	426151-041	
5 X 4 X 11 1/2	D. I.	426152-031	
6 X 5 X 11 1/2	B. F.	426155-011	
6 X 5 X 11 1/2	A. B.	426155-041	
6 X 5 X 11 1/2	D. I.	426156-031	

CASINGS CONTINUED ON PAGE 6

4280 PUMP PARTS

CENTERLINE DISCHARGE

"M" SIZE 1 1/4" IMPELLER BORE ----- 1 5/8" MECHANICAL SEAL

ITEM 100 CASING (cont'd)

PUMP SIZE	CONST.	PART NUMBER	BAR CODE
8 X 6 X 11 1/2	B. F.	426159-011	
8 X 6 X 11 1/2	A. B.	426159-041	
8 X 6 X 11 1/2	D. I.	426160-031	
3 X 1 1/2 X 13	B. F.	426607-011	
3 X 1 1/2 X 13	A. B.	426607-041	
3 X 1 1/2 X 13	D. I.	426608-031	
3 X 2 X 13	B. F.	426165-011	
3 X 2 X 13	A. B.	426165-041	
3 X 2 X 13	D. I.	426166-031	
4 X 3 X 13	B. F.	426169-011	
4 X 3 X 13	A. B.	426169-041	
4 X 3 X 13	D. I.	426170-031	
6 X 4 X 13	B. F.	426173-011	
6 X 4 X 13	A. B.	426173-041	
6 X 4 X 13	D. I.	426174-031	
6 x 5 x 13	B.F. & A.I.	427191-011	
6 x 5 x 13	D.I.	427192-031	
6 x 5 x 13H	B.F. & A.I.	427191-017	
6 x 5 x 13H	D.I.	427192-037	

CASINGS CONTINUED ON PAGE 7

4280 PUMP PARTS

CENTERLINE DISCHARGE

"M" SIZE 1 1/4" IMPELLER BORE ----- 1 5/8" MECHANICAL SEAL

ITEM 100 CASING (cont'd)

PUMP SIZE	CONST.	PART NUMBER	BAR CODE
8 X 6 X 13	B. F.	426177-011	
8 X 6 X 13	A. B.	426177-041	
8 X 6 X 13	D. I.	426178-031	

4280 PUMP PARTS

CENTERLINE DISCHARGE

"M" SIZE 1 1/4" IMPELLER BORE ----- 1 5/8" MECHANICAL SEAL

ITEM 80 IMPELLER*

PUMP SIZE	CONSTRUCTION	PART NUMBER	BAR CODE
4 X 3 X 6W	B. F. & A. B.	427118-041	
4 X 3 X 6W	A. I.	427118-011	
1 1/2 X 1 X 8	B. F. & A. B.	426229-041	
1 1/2 X 1 X 8	A. I.	426229-011	
3 X 1 1/2 X 8	B. F. & A. B.	427122-041	
3 X 1 1/2 X 8	A. I.	427122-011	
3 X 2 X 8	B. F. & A. B.	427126-041	
3 X 2 X 8	A. I.	427126-011	
3 X 2 1/2 X 8	B. F. & A. B.	427128-041	
3 X 2 1/2 X 8	A. I.	427128-011	
4 X 3 X 8	B. F. & A. B.	427130-041	
4 X 3 X 8	A. I.	427130-011	
5 X 4 X 8	B. F. & A. B.	427138-041	
5 X 4 X 8	A. I.	427138-011	
6 X 4 X 8W	B. F. & A. B.	427138-041	
6 X 4 X 8W	A. I.	427138-041	
8 X 8 X 8	B. F. & A. B.	427918-041	
8 X 8 X 8	A. I.	427918-011	

Notes: * Impeller Part Numbers are for unbalanced, full diameter impellers. Always specify the Pump Serial Number. If possible, measure the diameter of the impeller being replaced.

IMPELLERS CONTINUED ON PAGE 9

4280 PUMP PARTS

CENTERLINE DISCHARGE

"M" SIZE 1 1/4" IMPELLER BORE ----- 1 5/8" MECHANICAL SEAL

ITEM 80 IMPELLER* (cont'd)

PUMP SIZE	CONSTRUCTION	PART NUMBER	BAR CODE
2 X 1 X 10	B. F. & A. B.	427152-041	
2 X 1 X 10	A. I.	427152-011	
2 X 1.5 X 10	B. F. & A. B.	426255-041	
2 X 1.5 X 10	A. I.	426255-011	
3 X 1 1/2 X 10	B. F.	427152-041	
3 X 1 1/2 X 10	A. I.	427152-011	
3 X 2 X 10	B. F. & A. B.	427164-041	
3 X 2 X 10	A. I.	427164-011	
3 X 2 1/2 X 10	B. F. & A. B.	427124-041	
3 X 2 1/2 X 10	A. I.	427124-011	
4 X 3 X 10	B. F. & A. B.	427150-041	
4 X 3 X 10	A. I.	427150-011	
5 X 4 X 10	B. F.	427154-041	
5 X 4 X 10	A. I.	427154-011	
6 X 4 X 10	B. F.	427154-041	
6 X 4 X 10	A. I.	427154-011	
6 X 5 X 10	B. F.	427160-041	
6 X 5 X 10	A. I.	427160-011	
8 X 6 X 10	B. F.	427157-041	
8 X 6 X 10	A. I.	427157-011	
4 X 3 X 11 1/2	B. F.	426282-041	
4 X 3 X 11 1/2	A. I.	426282-011	

Notes: * Impeller Part Numbers are for unbalanced, full diameter impellers. Always specify the Pump Serial Number. If possible, measure the diameter of the impeller being replaced.

IMPELLERS CONTINUED ON PAGE 10

4280 PUMP PARTS

CENTERLINE DISCHARGE

"M" SIZE 1 1/4" IMPELLER BORE ----- 1 5/8" MECHANICAL SEAL

ITEM 80 IMPELLER* (cont'd)

PUMP SIZE	CONSTRUCTION**	PART NUMBER	BAR CODE
5 X 4 X 11 1/2	B. F.	426284-041	
5 X 4 X 11 1/2	A. I.	426284-011	
6 X 5 X 11 1/2	B. F.	426288-041	
6 X 5 X 11 1/2	A. I.	426288-011	
8 X 6 X 11 1/2	B. F.	426289-041	
8 X 6 X 11 1/2	A. I.	426289-011	
3 X 1 1/2 X 13	B. F.	427161-041	
3 X 1 1/2 X 13	A. I.	427161-011	
3 X 2 X 13	B. F.	427165-041	
3 X 2 X 13	A. I.	427165-011	
4 X 3 X 13	B. F.	427169-041	
4 X 3 X 13	A. I.	427169-011	
6 X 4 X 13	B. F.	427173-041	
6 X 4 X 13	A. I.	427173-011	
6 x 5 x 13	B.F.	427182-041	
6 x 5 x 13H	B.F.	427177-041	
8 X 6 X 13	B. F.	427177-041	
8 X 6 X 13	A. I.	427177-011	

Notes: * Impeller Part Numbers are for unbalanced, full diameter impellers. Always specify the Pump Serial Number. If possible, measure the diameter of the impeller being replaced.

4280 PUMP PARTS

CENTERLINE DISCHARGE

"M" SIZE 1 1/4" IMPELLER BORE ----- 1 5/8" MECHANICAL SEAL

ITEM 40 & 50 COMB. STUFF. BOX & ADAPTER				
BRONZE FITTED (B.F.) & ALL IRON (A.I.) CONSTRUCTION				
PUMP SIZE	MOTOR FRAME			
	254-256JM	284-326JM	213-215JP	284-326JP
4 X 3 X 6W	426748-011			
1 1/2 X 1 X 8			426750-011	
3 X 1 1/2 X 8	426751-011	426752-011	426750-011	
3 X 2 X 8	426751-011	426752-011	426750-011	
3 X 2 1/2 X 8	426751-011	426752-011		
4 X 3 X 8	426751-011	426752-011	426750-011	
5 X 4 X 8	426751-015	426752-015	426750-015	
6 X 4 X 8W	426751-015	426752-015	426750-015	
8 X 8 X 8	426751-015		426750-015	
2 X 1 X 10	426755-011		426754-011	426756-011
2 X 1.5 X 10	426755-011		426754-011	426756-011
3 X 1 1/2 X 10	426755-011		426754-011	426756-011
3 X 2 X 10	426755-011		426754-011	426756-011
3 X 2 1/2 X 10	426755-015		426754-015	426756-015
4 X 3 X 10	426755-015		426754-015	
5 X 4 X 10	426755-015		426754-011	426756-011
6 X 4 X 10	426755-015		426754-011	426756-011
6 X 5 X 10	426755-011		426754-011	426756-011
8 X 6 X 10	426755-011			426756-011
4 X 3 X 11 1/2	426742-011		426743-011	426744-011
5 X 4 X 11 1/2	426742-011		426743-011	426744-011
6 X 5 X 11 1/2	426742-011			426744-011
8 X 6 X 11 1/2	426742-011			426744-011

CONTINUED ON PAGE 12

SEE PAGE 12 FOR BAR CODES

4280 PUMP PARTS

CENTERLINE DISCHARGE

"M" SIZE 1 1/4" IMPELLER BORE ----- 1 5/8" MECHANICAL SEAL

ITEM 40 & 50 COMB. STUFF. BOX & ADAPTER

BRONZE FITTED (B.F.) & ALL IRON (A.I.) CONSTRUCTION

PUMP SIZE	MOTOR FRAME			
	254-256JM	284-326JM	213-215JP	284-326JP
3 X 1 1/2 X 13	426759-011	426375-111		426758-011
3 X 2 X 13	426759-011	426375-111		426758-011
4 X 3 X 13	426759-011	426375-111	SEE PAGE 17	426758-011
6 X 4 X 13	426759-011	426375-112	SEE PAGE 17	426758-011
6 x 5 x 13	426759-011	426375-112	SEE PAGE 17	426758-011
6 x 5 x 13H	426759-011	426375-112	SEE PAGE 17	426758-011
8 X 6 X 13	426759-011	426375-112	SEE PAGE 17	426758-011

BAR CODES

426375-111		426752-011	
426375-112		426752-015	
426742-011		426754-011	
426743-011		426754-015	
426744-011		426755-011	
426748-011		426755-015	
426750-011		426756-011	
426750-015		426756-015	
426751-011		426758-011	
426751-015		426759-011	

4280 PUMP PARTS

CENTERLINE DISCHARGE

"M" SIZE 1 1/4" IMPELLER BORE ----- 1 5/8" MECHANICAL SEAL

ITEM 40 & 50 COMB. STUFF. BOX & ADAPTER				
DUCTILE IRON CONSTRUCTION				
PUMP SIZE	MOTOR FRAME			
	254-256JM	284-326JM	213-215JP	284-326JP
4 X 3 X 6W	426748-031			
1 1/2 X 1 X 8			426750-031	
3 X 1 1/2 X 8	426751-031	426752-031	426750-031	
3 X 2 X 8	426751-031	426752-031	426750-031	
3 X 2 1/2 X 8	426751-031	426752-031		
4 X 3 X 8	426751-031	426752-031	426750-031	
5 X 4 X 8	426751-035	426752-035	426750-035	
6 X 4 X 8W	426751-035	426752-035	426750-035	
8 X 8 X 8	426751-035		426750-035	
2 X 1 X 10	426755-031		426754-031	426756-031
2 X 1.5 X 10	426755-031		426754-031	426756-031
3 X 1 1/2 X 10	426755-031		426754-031	426756-031
3 X 2 X 10	426755-031		426754-031	426756-031
3 X 2 1/2 X 10	426755-035		426754-031	426756-035
4 X 3 X 10	426755-035		426754-035	
5 X 4 X 10	426755-035		426754-031	426756-031
6 X 4 X 10	426755-035		426754-031	426756-031
6 X 5 X 10	426755-031		426754-031	426756-031
8 X 6 X 10	426755-031			426756-031
4 X 3 X 11 1/2	426742-031		426743-031	426744-031
5 X 4 X 11 1/2	426742-031		426743-031	426744-031
6 X 5 X 11 1/2	426742-031			426744-031
8 X 6 X 11 1/2	426742-031			426744-031

CONTINUED ON PAGE 14

SEE PAGE 14 FOR BAR CODES

4280 PUMP PARTS

CENTERLINE DISCHARGE

"M" SIZE 1 1/4" IMPELLER BORE ----- 1 5/8" MECHANICAL SEAL

ITEM 40 & 50 COMB. STUFF. BOX & ADAPTER DUCTILE IRON CONSTRUCTION

PUMP SIZE	MOTOR FRAME			
	254-256JM	284-326JM	213-215JP	284-326JP
3 X 1 1/2 X 13	426759-031	426375-131		426758-031
3 X 2 X 13	426759-031	426375-131		426758-031
4 X 3 X 13	426759-031	426375-131	SEE PAGE 17	426758-031
6 X 4 X 13	426759-031	426375-132	SEE PAGE 17	426758-031
6 x 5 x 13	426759-031	426375-132	SEE PAGE 17	426758-031
6 x 5 x 13H	426759-031	426375-132	SEE PAGE 17	426758-031
8 X 6 X 13	426759-031	426375-132	SEE PAGE 17	426758-031

BAR CODES

426375-131		426752-031	
426375-132		426752-035	
426742-031		426754-031	
426743-031		426754-035	
426744-031		426755-031	
426748-031		426755-035	
426750-031		426756-031	
426750-035		426756-035	
426751-031		426758-031	
426751-015		426759-031	

4280 PUMP PARTS

CENTERLINE DISCHARGE

"M" SIZE 1 1/4" IMPELLER BORE ----- 1 5/8" MECHANICAL SEAL

ITEM 40 & 50 COMB. STUFF. BOX & ADAPTER				
ALL BRONZE CONSTRUCTION				
PUMP SIZE	MOTOR FRAME			
	254-256JM	284-326JM	213-215JP	284-326JP
4 X 3 X 6W	426748-041			
1 1/2 X 1 X 8			426750-041	
3 X 1 1/2 X 8	426751-041	426752-041	426750-041	
3 X 2 X 8	426751-041	426752-041	426750-041	
3 X 2 1/2 X 8	426751-041	426752-041		
4 X 3 X 8	426751-041	426752-041	426750-041	
5 X 4 X 8	426751-045	426752-041	426750-045	
6 X 4 X 8W	426751-045	426752-045	426750-045	
8 X 8 X 8	426751-045		426750-045	
2 X 1 X 10	426755-041		426754-041	426756-041
2 X 1.5 X 10	426755-041		426754-041	426756-041
3 X 1 1/2 X 10	426755-041		426754-041	426756-041
3 X 2 X 10	426755-041		426754-041	426756-041
3 X 2 1/2 X 10	426755-045		426754-045	426756-045
4 X 3 X 10	426755-045		426754-045	
5 X 4 X 10	426755-045		426754-041	426756-041
6 X 4 X 10	426755-045		426754-041	426756-041
6 X 5 X 10	426755-041		426754-041	426756-041
8 X 6 X 10	426755-041			426756-041
4 X 3 X 11 1/2	426742-041		426743-011	426744-041
5 X 4 X 11 1/2	426742-041		426743-011	426744-041
6 X 5 X 11 1/2	426742-011			426744-041
8 X 6 X 11 1/2	426742-011			426744-041

CONTINUED ON PAGE 16

SEE PAGE 16 FOR BAR CODES

4280 PUMP PARTS

CENTERLINE DISCHARGE

"M" SIZE 1 1/4" IMPELLER BORE ----- 1 5/8" MECHANICAL SEAL

ITEM 40 & 50 COMB. STUFF. BOX & ADAPTER

ALL BRONZE CONSTRUCTION

PUMP SIZE	MOTOR FRAME			
	254-256JM	284-326JM	213-215JP	284-326JP
3 X 1 1/2 X 13	426759-041	426375-141		426758-041
3 X 2 X 13	426759-041	426375-141		426758-041
4 X 3 X 13	426759-041	426375-141	SEE PAGE 17	426758-041
6 X 4 X 13	426759-041	426375-142	SEE PAGE 17	426758-041
6 x 5 x 13	426759-041	426375-142	SEE PAGE 17	426758-041
6 x 5 x 13H	426759-041	426375-142	SEE PAGE 17	426758-041
8 X 6 X 13	426759-041	426375-142	SEE PAGE 17	426758-041

BAR CODES

426375-141		426752-041	
426375-142		426752-045	
426742-041		426754-041	
426743-041		426754-045	
426744-041		426755-041	
426748-041		426755-045	
426750-041		426756-041	
426750-045		426756-045	
426751-041		426758-041	
426751-045		426759-041	

4280 PUMP PARTS

CENTERLINE DISCHARGE

"M" SIZE 1 1/4" IMPELLER BORE ----- 1 5/8" MECHANICAL SEAL

ITEM 40 ADAPTER		
MOTOR FRAMES 213 - 215JP		
PUMP SIZE	PART NUMBER	BAR CODE
4 X 3 X 13	FOR B.F. - D.I. & A.B. CONSTRUCTIONS 426388-111	
6 X 4 X 13		
6 x 5 x 13		
6 x 5 x 13H		
8 X 6 X 13		

ITEM 50 STUFFING BOX			
MOTOR FRAMES 213 - 215JP			
PUMP SIZE	CONST.	PART NUMBER	BAR CODE
4 X 3 X 13	B.F.	426545-111	
6 X 4 X 13			
6 x 5 x 13	D.I.	426545-131	
6 x 5 x 13H	A.B.	426545-141	
8 X 6 X 13			

4280 PUMP PARTS

CENTERLINE DISCHARGE

"M" SIZE 1 1/4" IMPELLER BORE ----- 1 5/8" MECHANICAL SEAL

ITEM 101 CASING GASKET

PUMP SIZE	PART NUMBER	BAR CODE
4X3X6W	426401-002	
1 1/2 X 1 X 8 3 X 1 1/2 X 8 3 X 2 X 8 3 X 2 1/2 X 8 4 X 3 X 8 5 X 4 X 8 6 X 4 X 8W 8 X 8 X 8	426401-003	
2 X 1 X 10 2 X 1.5 X 10 3 X 1 1/2 X 10 3 X 2 X 10 3 X 2 1/2 X 10 4 X 3 X 10 5 X 4 X 10 6 X 4 X 10 6 X 5 X 10 8 X 6 X 10	426401-004	
4 X 3 X 11 1/2 5 X 4 X 11 1/2 6 X 5 X 11 1/2 8 X 6 X 11 1/2	426401-006	
3 X 1 1/2 X 13 3 X 2 X 13 4 X 3 X 13 6 X 4 X 13 6 x 5 x 13 6 x 5 x 13H 8 X 6 X 13	426401-005	

4280 PUMP PARTS

CENTERLINE DISCHARGE

"M" SIZE 1 1/4" IMPELLER BORE ----- 1 5/8" MECHANICAL SEAL

ITEM 44 MOTOR CAPSCREW & WASHER

PUMP SIZE	MOTOR FRAME			
	254-256JM	284-326JM	213-215JP	284-326JP
	4 REQUIRED	4 REQUIRED	4 REQUIRED	4 REQUIRED
4 X 3 X 6W	CAPSCREW 1/2"-13NC 1 1/4" LONG 911125-110	CAPSCREW 5/8"-11NC 1 1/4" LONG 911129-110	CAPSCREW 1/2"-13NC 1 1/4" LONG 911125-110	
1 1/2 X 1 X 8				
3 X 1 1/2 X 8				
3 X 2 X 8				
3 X 2 1/2 X 8				
4 X 3 X 8				
5 X 4 X 8				
6 x 4 x 8W				
8 X 8 X 8				
2 X 1 X 10		WASHER 1/2" FLAT 927117-100		
2 X 1.5 X 10				
3 X 1 1/2 X 10				
3 X 2 X 10				
3 X 2 1/2 X 10				
4 X 3 X 10				
5 X 4 X 10				
6 X 4 X 10				
6 X 5 X 10				
8 X 6 X 10				
4 X 3 X 11 1/2	CAPSCREW 5/8"-11NC 1 3/4" LONG 911129-114	WASHER 5/8" FLAT 927121-100		WASHER 5/8" FLAT 927121-100
5 X 4 X 11 1/2				
6 X 5 X 11 1/2				
8 X 6 X 11 1/2				
3 X 1 1/2 X 13				
3 X 2 X 13				
4 X 3 X 13				
6 X 4 X 13				
6 x 5 x 13				
6 x 5 x 13H				
8 X 6 X 13				

BAR CODES

911125-110		911129-114	
911129-110		927117-100	
911129-112		927121-100	

4280 PUMP PARTS

CENTERLINE DISCHARGE

"M" SIZE 1 1/4" IMPELLER BORE ----- 1 5/8" MECHANICAL SEAL

ITEM 104 CASING CAPSCREW & WASHER

PUMP SIZE	NO. REQ'D	SIZE	PART NUMBER	BAR CODE
4 X 3 X 6W	8	CAPSCREW 1/2" - 13NC X 1 1/4"LG.	911125-110	
	8	WASHER 1/2" - SAE FLAT	927117-100	
1 1/2 X 1 X 8 3 X 1 1/2 X 8 3 X 2 X 8 3 X 2 1/2 X 8 4 X 3 X 8 5 X 4 X 8 6 X 4 X 8 8 X 8 X 8	8	HX. HD. CAPSCREW 5/8" - 11NC X 1 1/2"LG.	911129-112	
	8	WASHER 5/8" - SAE FLAT	927121-100	
2 X 1 X 10 2 X 1.5 X 10 3 X 1 1/2 X 10 3 X 2 X 10 3 X 2 1/2 X 10 4 X 3 X 10 5 X 4 X 10 6 X 4 X 10 6 X 5 X 10 8 X 6 X 10	12	CAPSCREW 5/8" - 11NC X 1 1/2"LG.	911129-112	
	12	WASHER 5/8 - SAE FLAT	927121-100	
4 X 3 X 11 1/2 5 X 4 X 11 1/2 6 X 5 X 11 1/2 8 X 6 11 1/2	12	CAPSCREW 1/2" - 13NC X 1 1/2"LG.	911125-112	
	12	WASHER 1/2" - SAE FLAT	927117-100	
3 X 1 1/2 X 13 3 X 2 X 13 4 X 3 X 13 6 X 4 X 13 6 x 5 x 13 6 x 5 x 13H 8 X 6 X 13	16	CAPSCREW 5/8" - 11NC X 1 1/2"LG.	911129-112	
	12	WASHER 5/8 - SAE FLAT	927121-100	

4280 PUMP PARTS

CENTERLINE DISCHARGE

"M" SIZE 1 1/4" IMPELLER BORE ----- 1 5/8" MECHANICAL SEAL

COMMON PARTS				
ITEM NO.	DESCRIPTION	CONST.	PART NUMBER	BAR CODE
70	SHAFT SLEEVE FRAMES 254-256 & 284-326JM	B.F.	425869-003	
70	SHAFT SLEEVE FRAMES 254-256 & 284-326JM	A.I.	425869-004	
70	SHAFT SLEEVE FRAMES 213-215 & 284-326JP	B.F.	425869-021	
70	SHAFT SLEEVE FRAMES 213-215 & 284-326JP	A.I.	425869-022	
62	MECHANICAL SEAL KIT	ALL	975000-984**	
71	SLEEVE SPACER	ALL	425868-004	
39	WATER SLINGER	ALL	419315-000	
83	IMPELLER WASHER	ALL	425742-003	
84	IMPELLER LOCKWASHER	ALL	927213-400	
86	IMPELLER CAPSCREW	ALL	911900-119	

** For liquids above 200°F/93°C use 9975001-833 (-633 if potable drinking water above 200°F/93°C)
For glycols above 30% by weight use 9975001-837 (-838 if above 200°F/93°C)

ITEMS 70 & 71 SHAFT SLEEVE & SPACER KITS				
ITEM	DESCRIPTION	CONST.	PART	BAR CODE
70 & 71	SHAFT SLV. & SPACER KIT FRAMES 254-256 & 284-326JM	B.F.	810150-154	
70 & 71	SHAFT SLV. & SPACER KIT FRAMES 254-256 & 284-326JM	A.I.	810150-155	
70 & 71	SHAFT SLV. & SPACER KIT FRAMES 213-215 & 284-326JP	B.F.	810150-152	
70 & 71	SHAFT SLV. & SPACER KIT FRAMES 213-215 & 284-3JP26	A.I.	810150-153	