

**ARMSTRONG**



## Wet Rotor Circulators

FILE NO:	10.128IN
DATE:	May 25, 2011
SUPERSEDES:	10.128IN
DATE:	April 12, 2011

► Dimensions and Weights

Cast Iron	Part No.	A	B	C	D	Connection Type & Size	Weight	Perf. Curve
AG-R 225-40-1	110223-530	130	130	105	130	Union 1½" x 1" BSPT	3.2	A
AG-R 225-50-1	110223-531	130	130	105	130	Union 1½" x 1" BSPT	3.3	B
AG-R 232-60-1	110223-532	180	130	105	130	Union 2" x 1¼" BSPT	3.8	C
AG-R 232-80-1	110223-533	180	150	130	160	Union 2" x 1¼" BSPT	5.5	D
AG-R 225-40-1-180	110223-534	180	130	105	130	Union 1½" x 1" BSPT	3.2	A
AG-R 225-50-1-180	110223-535	180	130	105	130	Union 1½" x 1" BSPT	3.3	B
AG-R 232-60-1-1.5"	110223-536	180	130	105	130	Union 2" x 1½" BSPT	3.8	C
AG-R 232-80-1-1.5"	110223-537	180	150	130	160	Union 2" x 1½" BSPT	5.5	D
AG-R 232-50-1	110223-538	180	130	105	130	Union 2" x 1¼" BSPT	3.3	B

Note: All dimensions are in mm and weights are in kg.

► Motor Data

Model	Speed	Full Load Amp Draw (A)	Nominal Power (W)
AG-R 225-40-1/ AG-R 225-40-1-180	3 2 1	0.32 0.24 0.16	66
AG-R 225-50-1/ AG-R 225-50-1-180/ AG-R 232-50-1	3 2 1	0.39 0.32 0.22	86
AG-R 232-60-1 AG-R 232-60-1-1.5"	3 2 1	0.48 0.37 0.28	112
AG-R 232-80-1 AG-R 232-80-1-1.5"	3 2 1	1.23 0.95 0.77	271

► Materials of Construction

Pump Body: Cast Iron  
 Impeller: Polyether Imide (PEI)  
 Shaft: Ceramic  
 Bearings: Ceramic  
 Gasket Material: EPDM

► Technical Data

Flow Range: 0 - 10.5 m<sup>3</sup>/hr  
 Head Range: 0 - 8 m  
 Motor: 230V, single phase, 50 Hz  
 Max. Fluid Temperature\*: 110°C  
 Max. Working Pressure: 10 bar

Note: All models are three speeds.

Armstrong AG-R Series are 230 V/single phase/50 Hz and are CE and CB approved.

► Performance Curves

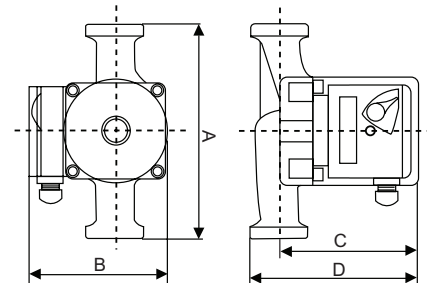
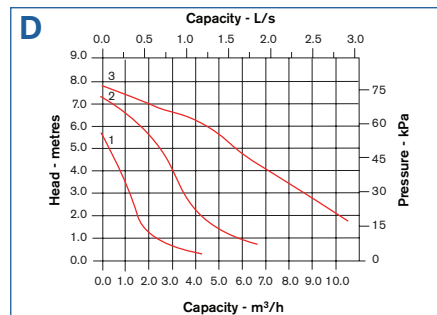
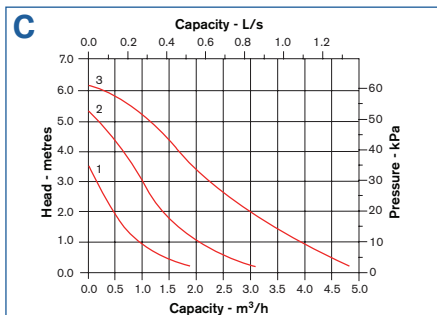
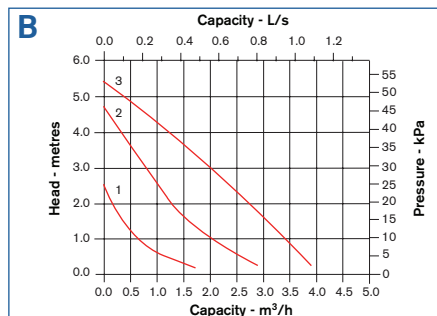
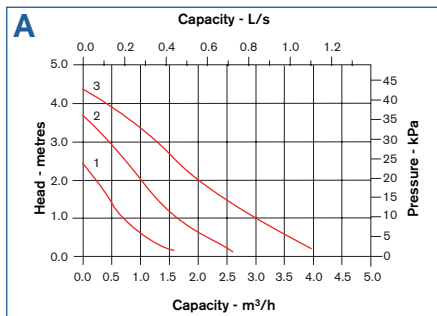

► Typical Specifications

Furnish and install, as shown on the plans, Armstrong AG-R Series circulating pump model \_\_\_\_\_ with cast iron body and PEI impeller. The pump shall have a capacity of \_\_\_\_\_ m<sup>3</sup>/hr against a total head of \_\_\_\_\_ meters.

\*As water conditions (i.e. dissolved solids) can vary with geographical location, it is recommended that the operating temperature of the fluid for open (potable) systems be kept as low as possible (i.e. below 150°F or 65°C) to avoid precipitation of calcium.

**S. A. Armstrong Limited**  
 23 Bertrand Avenue  
 Toronto, Ontario  
 Canada, M1L 2P3  
 T: 416-755-2291  
 F: 416-759-9101

**Armstrong Integrated Limited**  
 Wenlock Way  
 Manchester  
 United Kingdom, M12 5JL  
 T: +44 (0) 8444 145 145  
 F: +44 (0) 8444 145 146

